

# TIMBER SALE MAP



Douglas County Forestry Department  
 9182 East Hughes Avenue  
 P.O. Box 211  
 Solon Springs, WI 54873  
 Phone (715) 378-2219, Fax (715) 378-2807

TRACT NUMBER: 12-23

SALE NUMBER:

Prepared By: Logan Jones Legal: Section 15,16 & 22 T46N - R13W  
 Sale Name: Swing Set Town: Oakland Topography: Rolling Hills  
 Scale Method: Ticket Scale Acres: 61 Harvest Units: 3 Soils: Sandy Loam  
 Contract Period: 2 Years Map Scale: 4" = 1 mile Season: Seasonal (see reverse)

-- See the Douglas County Timber Sale Contract and reverse side for terms and conditions. --

## VICINITY MAP

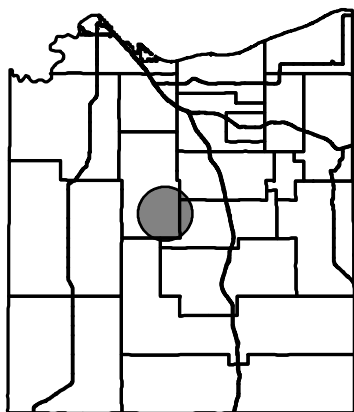

## SPECIES, PRICE & ESTIMATED VOLUME INFORMATION

SPECIES	4" ROUNDWOOD (CORDS)	WHOLE-TREE (CORDS)	SAWLOGS (MBF)	MINIMUM TOTAL SPECIES PRICE
White Birch	470	585	XXX	\$3,627.00
Mixed HW	440	535	XXX	\$3,584.50
Balsam Fir	90	125	XXX	\$187.50
<b>TOTALS</b>	<b>1,000</b>	<b>1,245</b>	<b>XXX</b>	<b>\$7,399.00</b>

The Mixed HW volume contains approximately 30% Basswood, 28% Red Oak, 22% Sugar Maple, 13% Aspen, 6% Red Maple, and 1% Misc. The Balsam Fir volume contains approximately 89% Balsam Fir and 11% Red Pine.

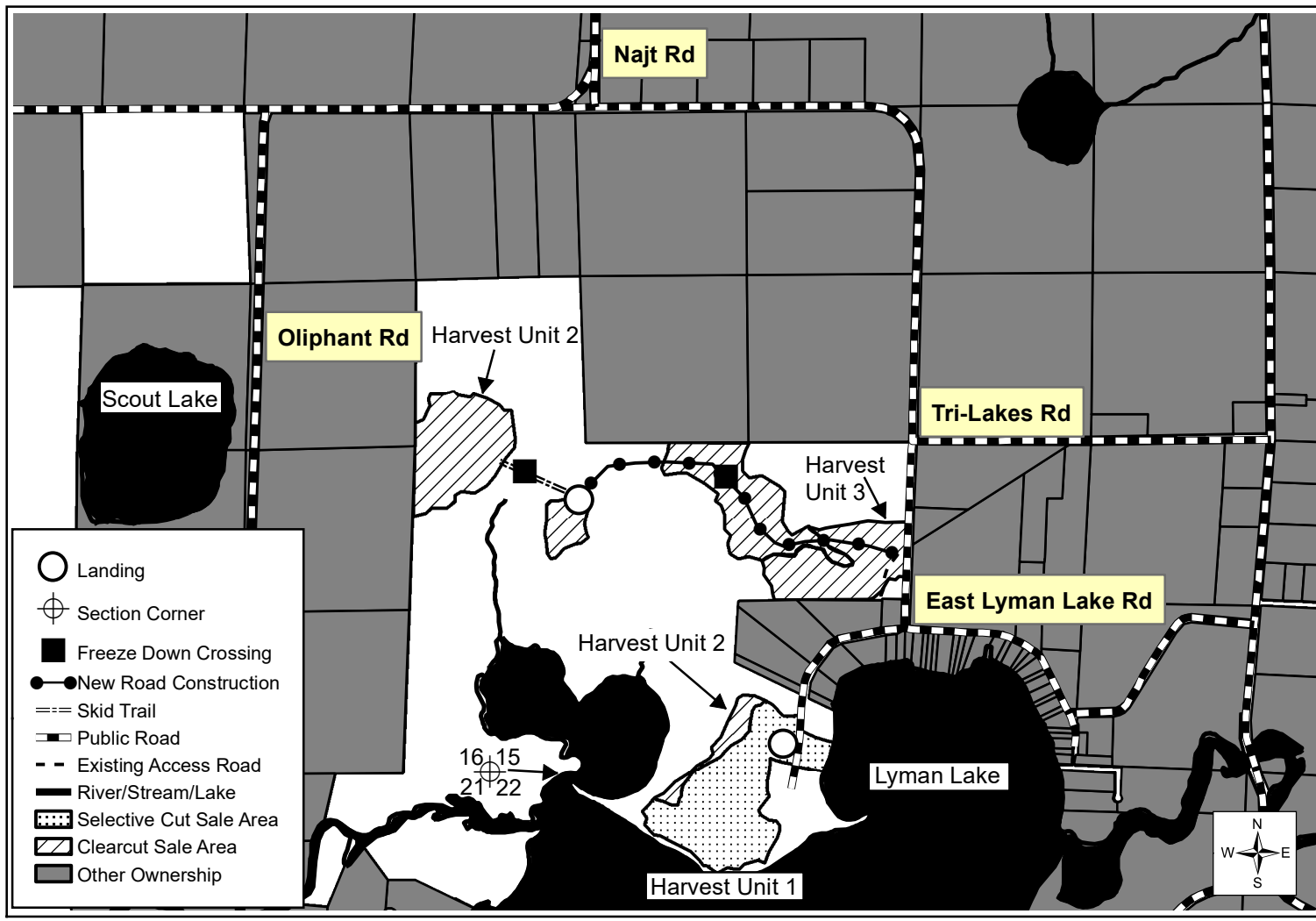

## **TRACT 12-23 (SWING SET) – SUPPLEMENTAL REQUIREMENTS**

The following terms and conditions supplement those provided in the Douglas County Timber Sale Contract:

### **A. PRESCRIPTION -**

- Harvest unit 1 has an all-aged single tree selection harvest prescription with an estimated average residual basal area of 80ft<sup>2</sup>.
- Harvest unit 2 has a seed tree harvest prescription with an estimated average residual basal area of 13ft<sup>2</sup>.
- Harvest unit 3 has an over-story removal harvest prescription with an estimated average residual basal area of 4ft<sup>2</sup>.

### **B. SEASONAL RESTRICTIONS -**

- In harvest unit 1, no harvesting operations shall be permitted from February 15<sup>th</sup> to August 1<sup>st</sup>.
- In harvest units 2 & 3, all harvesting operations shall be restricted from April 15<sup>th</sup> to July 15<sup>th</sup> due to Oak Wilt restrictions. After July 15<sup>th</sup> operations are not restricted on an estimated 70% of the harvest area (uplands) and shall be limited to frozen ground conditions only on an estimated 30% of the harvest area (lowlands). Contact the Sale Administrator for further information.

### **C. TREES DESIGNATED FOR CUTTING -**

- In harvest unit 1, fell all marked stems. Skid and haul all felled stems that meet the product and utilization standards as per product bid.
- In harvest unit 2, fell, skid, and haul all non-marked red maple, red oak, sugar maple, aspen, white birch, basswood, and balsam fir stems that meet the product and utilization standards as per product bid.
- In harvest unit 3, fell, skid, and haul all red oak, sugar maple, and miscellaneous species stems that meet the product and utilization standards as per product bid.

### **D. TREES DESIGNATED FOR LEAVING -**

- In harvest unit 1, reserve and leave undamaged all non-marked stems.
- In harvest unit 2, reserve and leave undamaged all white pine, red pine, white spruce and purple marked stems.
- In harvest unit 3 reserve and leave undamaged all burr oak stems.

### **E. HARVEST AND OPERATIONAL REQUIREMENTS -**

- In harvest unit 1 & 3, all harvesting operations shall be limited to short-wood/cut-to-length operations only. Sheared stems shall be limbed, topped, and processed at the stump prior to product forwarding. No pole-length or whole-tree skidding. "Whole-tree" product utilization is restricted to cut-to-length forwarder operations only. Contact the sale administrator for more information.
- In harvest unit 1, for contracted 4" roundwood cord product utilization, all slash must be pulled back at least 100 feet from the east sale boundary and uniformly concentrated and scattered as directed. This requirement is excluded within the 50 foot RMZ along Lyman Lake. Contact the Sale Administrator for further information.
- One skid trail "Freeze Down Crossing" shall be constructed as designated. All equipment operation and skidding in this portion of the sale area shall be limited to this crossing. Contact the Sale Administrator for further information.
- In harvest unit 1, the landing will be restricted to a small back-in turn-around
- Two landing locations and skid trail location will be identified during the pre-operations meeting.
- Access road system may be utilized for product decking.

### **F. ACCESS AND ROADS -**

- The total length of the access road system is approximately 3,400 feet. Approximately 400 feet of existing access road and 3,000 feet of new access road.
- The entire 3,000 feet of new access road will require "Class 3" construction.
- A 1,300 foot portion of the existing access road will require freeze down before use.
- One "Freeze Down Crossing" shall be constructed as designated.
- An "Earth Berm" shall be installed at a location designated by the Sale Administrator.

### **G. OTHER -**

- Harvest unit 1 is located within Anna-Gene County Park, a popular recreational area with diverse public interests. Operations will be highly visible and may attract special awareness. Contractors are encouraged to take the necessary steps to be as courteous and considerate as possible throughout all phases of operations.
- In harvest unit 1, hiking trails run through a significant portion of the harvest unit and are designated as a equipment restriction zone. No vehicle access, skidding, equipment operation, or decking of products is permitted on or along these trails. Designated trail crossing points shall be identified during the pre-operations meeting. All hauling, skidding, and equipment operation from one side of the trail to the other shall be limited to these crossings. All slash must be pulled back at least 8 feet from the trail edge, and shall be clear of all slash and harvest debris immediately upon harvesting. Trail crossings must be maintained in safe condition at all times as directed by the Sale Administrator. Use extra care and caution when crossing the trail.
- The hiking trails, access roads, skid trail, and landing locations requiring new construction are not marked in the field. The Sale Administrator will locate, identify, and flag these in during the pre-operations meeting.